

NA-L-35-1,0-A FL 35mm F/1.0

Athermalized

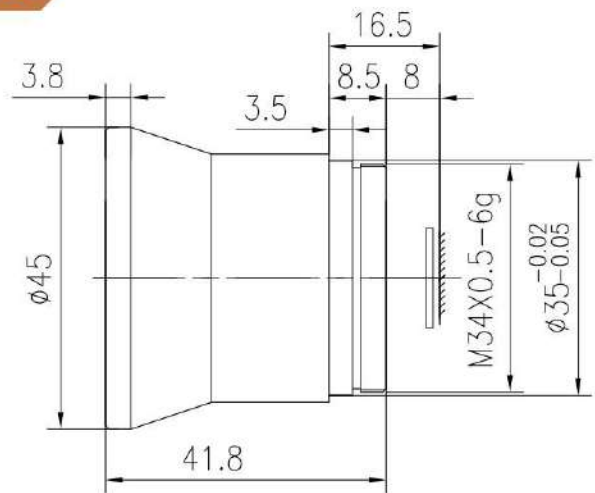

Property	Value	Remarks
Optics		
Focal Length	35mm	
F/#	1.0	
Wavelength	8~12 μm	
Average Transmission	$\geq 90\%$	
Detector	640*512 17 μm	
Back Focal Length	15.85mm	
Field of View	17.6° × 14.2°	
Mechanical		
Focus Mechanism	Fixed adjustable	
Focus Range	5m~ ∞	
Weight		
Dimensions	$\phi 45 \times 41.8$	
Back Working Distance	8mm	
Environmental		
Operating Temperature	-40°C~+80°C	
Storage Temperature	-40°C~+85°C	
Sealing	IP66(front lens only)	
Coating	AR	
Mechanical Shock	GJB150.16A	
Vibration	GJB150.18A	